

UNDERGROUND WIRELINE CROSSING APPLICATION INFORMATION

INFORMATION REQUIRED WITH APPLICATION: (Refer to drawing)

1. Name of applicant (show name to be used on documents).
If a corporation, show exact name of corporation and state of incorporation.
2. Name, mailing address and telephone, number of contact person.
3. Location of proposed crossing with respect to Railway's chainage station or milepost (indicate milepost number). Township, Range and Section in which the proposed work is located must be shown.
4. Distance from centerline of nearest track to end of casing (measured at right angles to railroad track). The casing shall extend to the greatest of 25 feet from centerline of track, 3 feet beyond ditch or 2 feet beyond toe of slope. Show angle of crossing with respect to railroad track.
5. Vertical clearance from base of rail to top of casing pipe (minimum 5 1/2 ft.). Minimum 3 ft. below bottom of ditch.
6. Indicate any fixed railroad structures in the vicinity of the proposed crossing such as bridges, signals, culverts or buildings.
7. Show orientation by north arrow as well as nearby towns.
8. If clearly indicated, show width of Railway right-of-way.
9. Application must clearly indicate the type of wire line and voltage (if applicable).
10. Inside and outside diameters of casing pipe and size of wire line must be shown. Casing shall be at least 2 inches greater ID than largest OD of wire line. Show insulators to be installed on wire line.
11. Material, grade and wall thickness of casing pipe must be shown.
12. Type of pipe joint and protective coating (if any) of casing pipe to be shown.
13. Method of installation "*dry boring*" and "*jacking*" **ONLY**.
14. Seals are required at each end to prevent formation of a waterway under the Railway. If lower end is above ground and drainage to carry leakage away from railway is available; seal may be omitted on lower end only.
15. Plans shall be drawn to scale showing the relation of the proposed pipeline to railway tracks, angle of crossing, locations of valves, railway survey station, right-of-way lines and general layout of tracks and railway facilities. Plans should also show a cross section (or sections) from field survey, showing pipe in relation to actual profile of ground and tracks. If open cutting or tunneling is necessary, details of sheeting and method of supporting tracks or driving tunnel shall be shown.

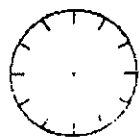
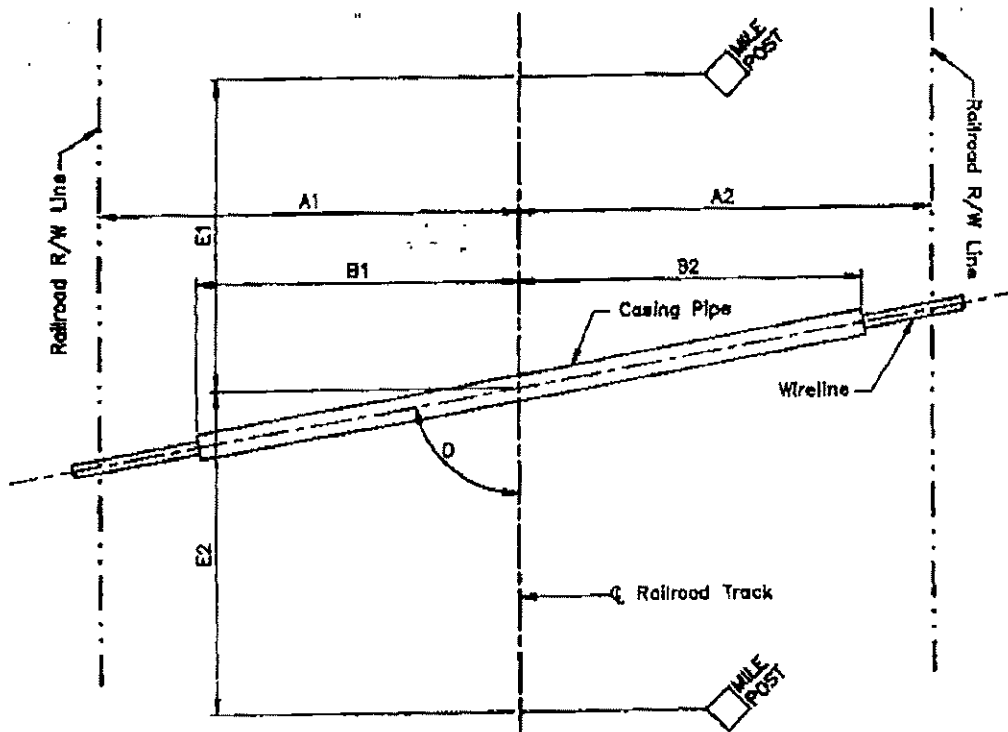

Indicate north direction
Show Township, Range
and Section in which
proposed work is to
be located.

TYPICAL PLAN VIEW

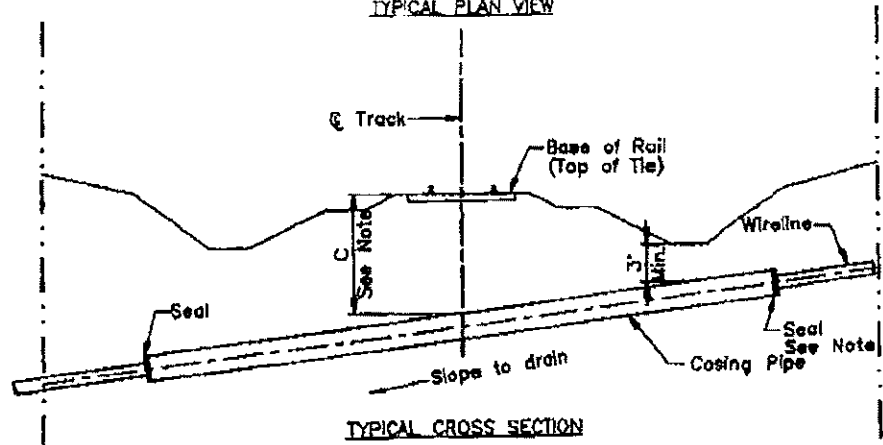

TYPICAL CROSS SECTION

SAMPLE PLAN FOR WIRE LINE CROSSING

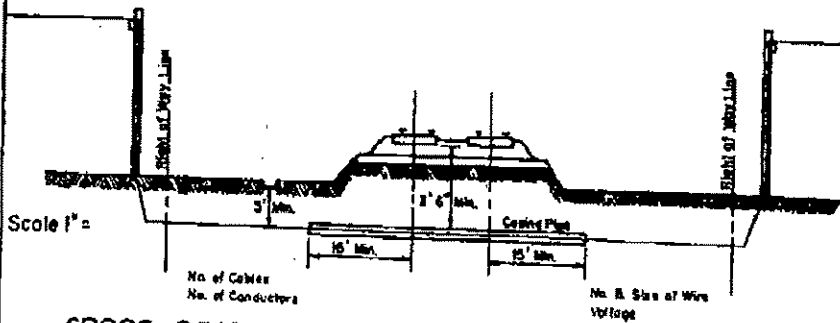
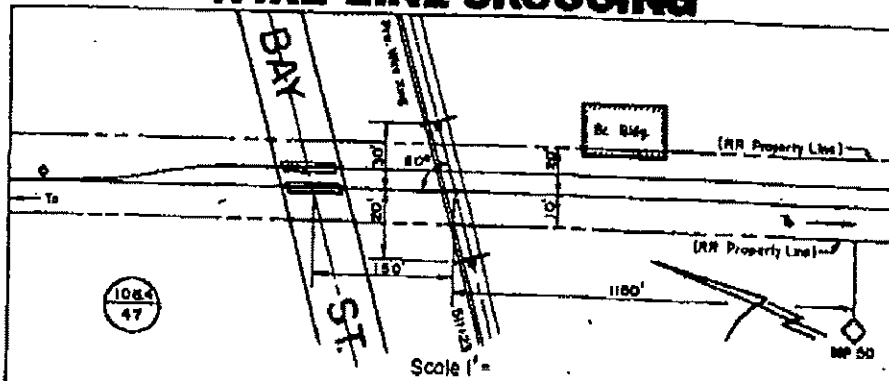

CROSS SECTION—UNDERGROUND WIRE LINE CROSSING

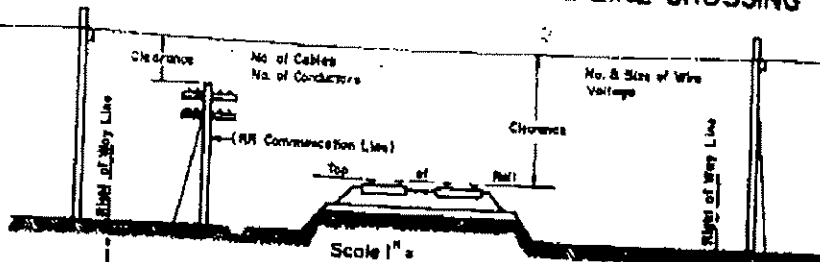

CROSS SECTION — AERIAL WIRE LINE CROSSING

NOTES
 No Coloring on Plans
 Size of Plan = 8 1/2" x 11"
 Plan and Profile—Drawn to Scale
 Cross Section from Field Survey
 Crossing Shall Comply With National
 Electric Safety Code Standards

JOHN Q. PUBLIC TELEPHONE CO.
 SPRUCE LOW GAP W. VA.
PROP WIRE LINE CROSSING
 SCALE AS SHOWN DATE: _____
 EXHIBIT "A"