

UNDERGROUND WIRELINE CROSSING APPLICATION INFORMATION

INFORMATION REQUIRED WITH APPLICATION: (Refer to drawing)

1. Name of applicant (show name to be used on documents).
If a corporation, show exact name of corporation and state of incorporation.
2. Name, mailing address and telephone, number of contact person.
3. Location of proposed crossing with respect to Railway's chainage station or milepost (indicate milepost number). Township, Range and Section in which the proposed work is located must be shown.
4. Distance from centerline of nearest track to end of casing (measured at right angles to railroad track). The casing shall extend to the greatest of 25 feet from centerline of track, 3 feet beyond ditch or 2 feet beyond toe of slope. Show angle of crossing with respect to railroad track.
5. Vertical clearance from base of rail to top of casing pipe (minimum 5 1/2 ft.). Minimum 3 ft. below bottom of ditch.
6. Indicate any fixed railroad structures in the vicinity of the proposed crossing such as bridges, signals, culverts or buildings.
7. Show orientation by north arrow as well as nearby towns.
8. If clearly indicated, show width of Railway right-of-way.
9. Application must clearly indicate the type of wire line and voltage (if applicable).
10. Inside and outside diameters of casing pipe and size of wire line must be shown. Casing shall be at least 2 inches greater ID than largest OD of wire line. Show insulators to be installed on wire line.
11. Material, grade and wall thickness of casing pipe must be shown.
12. Type of pipe joint and protective coating (if any) of casing pipe to be shown.
13. Method of installation "*dry boring*" and "*jacking*" **ONLY**.
14. Seals are required at each end to prevent formation of a waterway under the Railway. If lower end is above ground and drainage to carry leakage away from railway is available; seal may be omitted on lower end only.
15. Plans shall be drawn to scale showing the relation of the proposed pipeline to railway tracks, angle of crossing, locations of valves, railway survey station, right-of-way lines and general layout of tracks and railway facilities. Plans should also show a cross section (or sections) from field survey, showing pipe in relation to actual profile of ground and tracks. If open cutting or tunneling is necessary, details of sheeting and method of supporting tracks or driving tunnel shall be shown.

NO SCALE

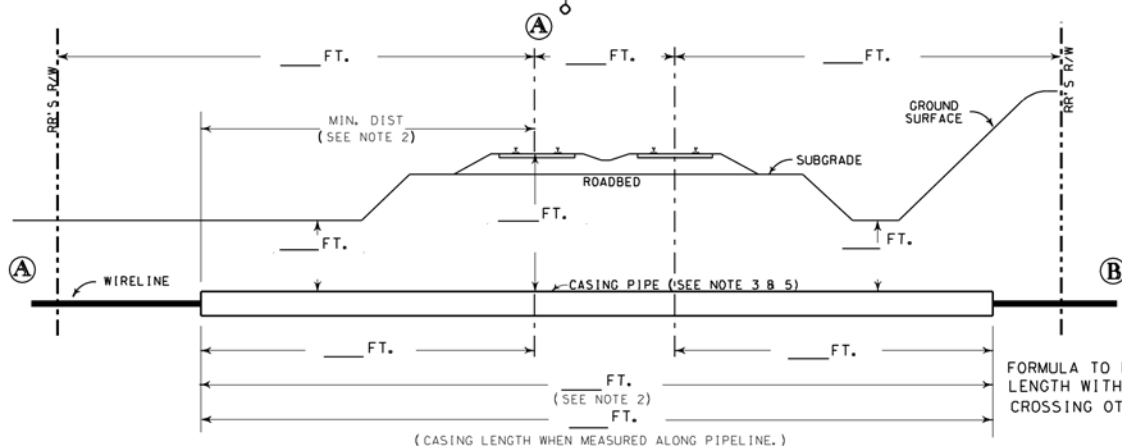
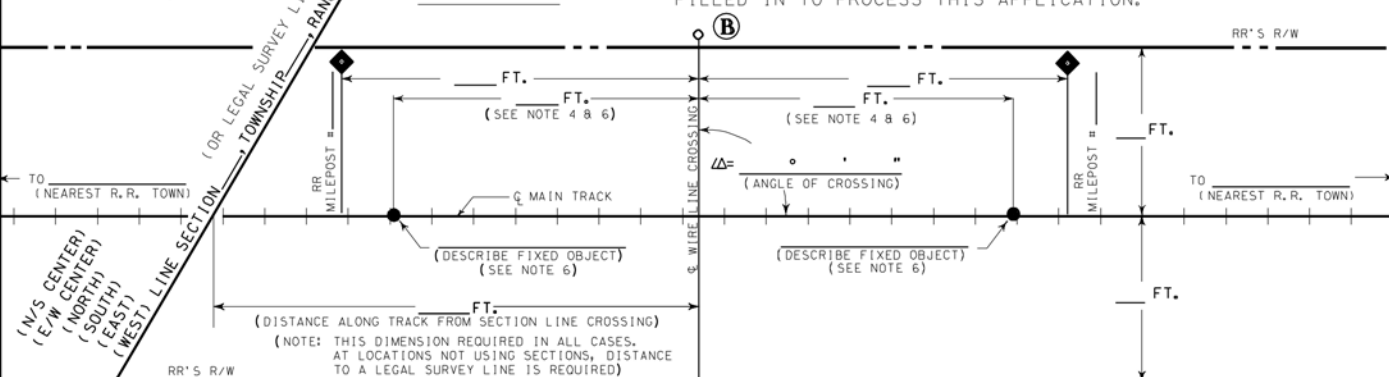

FORMULA TO FIGURE CASING
LENGTH WITH ANGLE OF
CROSSING OTHER THAN 90°

$$\frac{B}{\sin \Delta} \quad B$$

MIN. DIST
(NOTE 2)

- 1) ALL HORIZONTAL DISTANCES TO BE MEASURED AT RIGHT ANGLES FROM C/L OF TRACK, EXCEPT AS NOTED.
- 2) CASING MUST EXTEND A MINIMUM OF 30' OUT FROM C/L OF TRACK, MEASURED AT RIGHT ANGLES.
- 3) CASING MATERIAL : STEEL, RIGID METALLIC CONDUIT (NO PVC).
- 4) MINIMUM OF 50' FROM THE END OF ANY RAILROAD BRIDGE, C/L OF ANY CULVERT, OR FROM ANY SWITCH
- 5) SIGNAL REPRESENTATIVE MUST BE PRESENT DURING INSTALLATION IF RAILROAD SIGNALS ARE IN THE
- 6) ALLOWABLE FIXED OBJECTS INCLUDE: BACKWALLS OF BRIDGES; C/L OF ROAD CROSSINGS & OVERHEAD VIA
- 7) CASING AND CARRIER PIPE MUST BE PLACED A MINIMUM OF 2 FEET BELOW THE EXISTING FIBER OPTIC

5 FEET OF THE EXISTING FIBER OPTIC CABLE MUST BE HAND DUG.

A) IS WIRELINE CROSSING WITHIN DEDICATED STREET? ____ YES; ____ NO;
B) IF YES, NAME OF STREET _____
C) TYPE WIRELINE CROSSING: ____ TELEPHONE; ____ TELEVISION; ____ FIBER OPTIC;
OTHER; _____
D) VOLTAGE TO BE CARRIED UNDER TRACK _____ NO. OF WIRES _____
E) CASING TYPE TO BE INSTALLED _____
F) METHOD OF INSTALLING CASING PIPE UNDER TRACK(S):
____ DRY BORE AND JACK (WET BORE NOT PERMITTED);
____ TUNNEL; OTHER _____
G) DISTANCE FROM CENTER LINE OF TRACK TO NEAR FACE OF BORING AND
JACKING PITS WHEN MEASURED AT RIGHT ANGLES TO TRACK _____
(30" MIN.)
H) DISTANCE TO NEAREST ROAD CROSSING WITH SIGNAL LIGHTS OR GATES
(IF LESS THAN ONE MILE) _____

(FOR RAILROAD USE ONLY - DO NOT WRITE IN THIS BOX)

(SUBDIVISION)

M. P. _____ E. S. _____

UNDERGROUND WIRELINE CROSSING

(NEAREST RR STATION)

(COUNTY)

(STATE)

FOR _____

(APPLICANT)

RR FILE NO. _____ DATE _____